



# S2008 Section Bolt Tool<sup>®</sup>

## Operating Instructions

**DO NOT USE AN IMPACT WRENCH**

1.

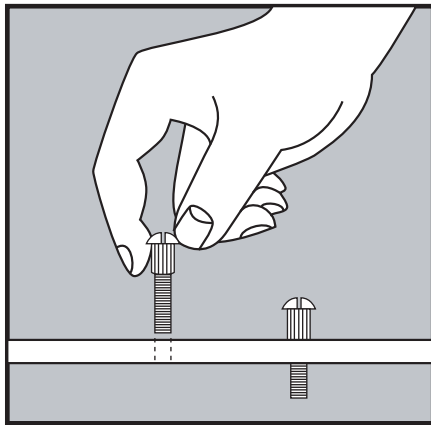

Drop bolt into hole in cutter bar.

2.

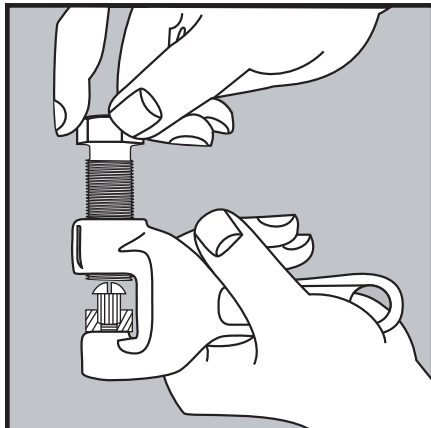

Position tool over bolt with concave end of tool screw directly over head of section bolt and hand tighten screw.

3.

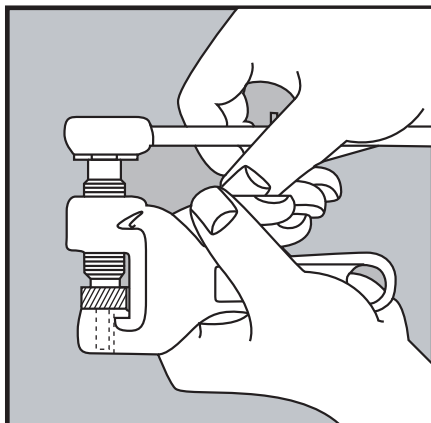

Using wrench, tighten tool screw to press section bolt head until flush with cutter bar.

**Replacement Parts: S2003 Drive Screw**

P.O. Box 17364 Wichita, Kansas 67217-0364 Phone (316) 942-8632

[www.smithtoolinfo.com](http://www.smithtoolinfo.com)